



46 TUDOR CLOSE, SEAFORD, BN25 2LX

£540,000

This extended, chain free, three double bedroom, detached house is situated approximately three quarters of a mile from Seaford town centre, railway station and beach.

The ground floor features a welcoming entrance hall, a spacious triple-aspect lounge of approximately 23 ft, a separate dining room, kitchen, conservatory, bedroom three, and a modern shower room.

The first floor benefits from a light landing, two double bedrooms together with a family bathroom.

Further features and benefits include, off road parking for two vehicles, good sized North Westerly rear garden, garage, gas central heating and uPVC double glazing.

- THREE DOUBLE BEDROOMS
- IMMEDIATE VACANT POSSESSION AND BEING SOLD CHAIN FREE
- GROUND FLOOR SHOWER ROOM AND FIRST FLOOR BATHROOM
- OFF ROAD PARKING AND GARAGE
- KITCHEN AND DINING ROOM
- EXTENDED TRIPLE ASPECT LOUNGE MEASURING APPROXIMATELY 23FT.
- DOUBLE GLAZED AND GAS FIRED CENTRAL HEATING
- SITUATED APPROXIMATELY THREE QUARTERS OF A MILE FROM SEAFORD TOWN CENTRE, RAILWAY STATION AND BEACH
- APPROXIMATELY HALF A MILE FROM CONVENIENCE STORE IN PRINCESS DRIVE AND SEAFORD PRIMARY SCHOOL



GROUND FLOOR  
104.0 sq.m. (1120 sq.ft.) approx.

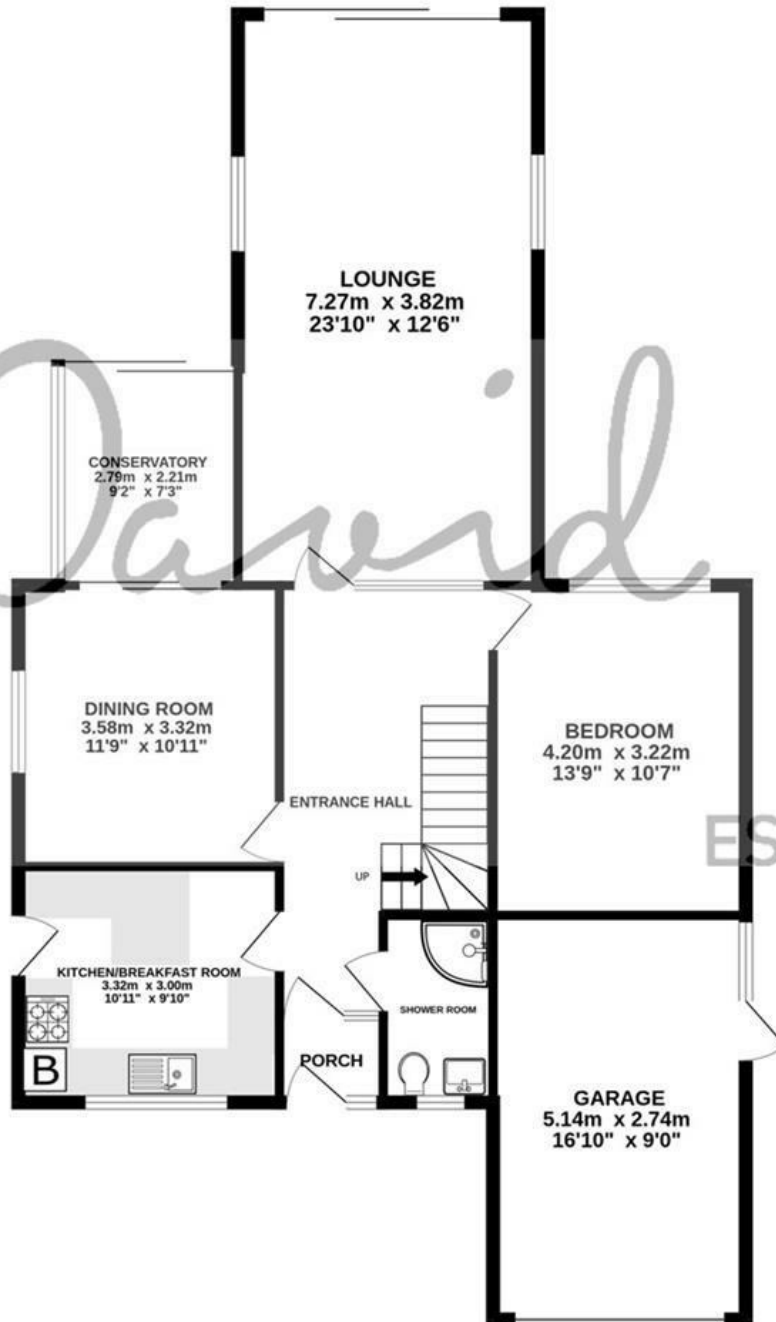

1ST FLOOR  
46.9 sq.m. (505 sq.ft.) approx.

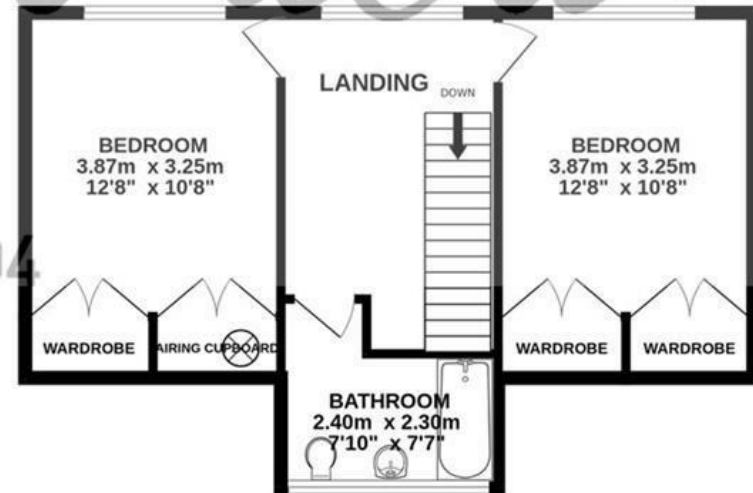

46 TUDOR CLOSE SEAFORD

TOTAL FLOOR AREA : 150.9 sq.m. (1625 sq.ft.) approx.

Whilst every attempt has been made to ensure the accuracy of the floorplan contained here, measurements of doors, windows, rooms and any other items are approximate and no responsibility is taken for any error, omission or mis-statement. This plan is for illustrative purposes only and should be used as such by any prospective purchaser. The services, systems and appliances shown have not been tested and no guarantee as to their operability or efficiency can be given.

Made with Metropix ©2025



## COUNCIL TAX BAND

Local Authority: Lewes District Council

Council Tax Band: E

## ENERGY PERFORMANCE CERTIFICATES (EPC)

Energy Efficiency Rating: D

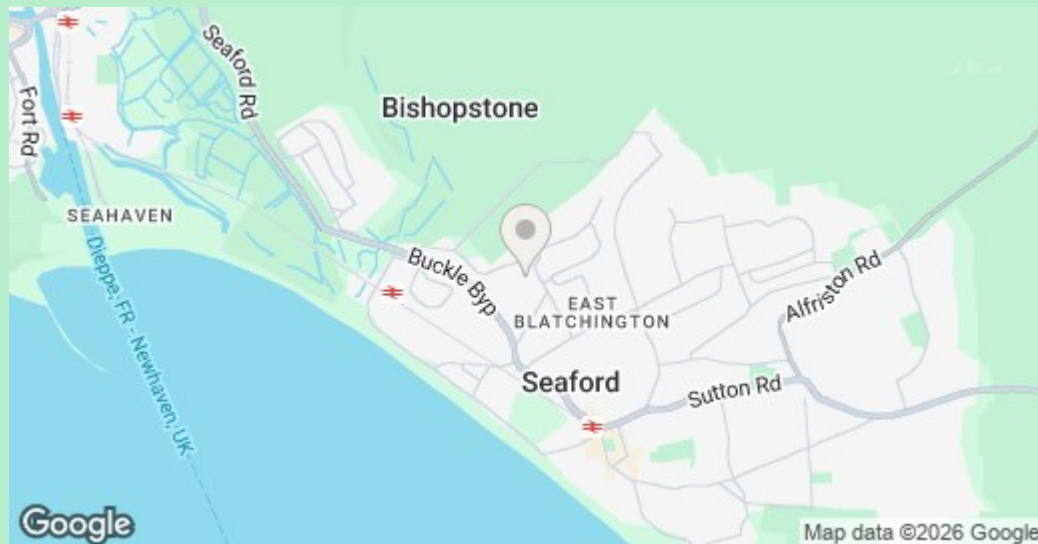

## DISCLAIMER

Money Laundering Regulations 2017: Intending purchasers will be asked to produce identification documentation upon acceptance of any offer. We would ask for your cooperation in producing such in order that there will not be a delay in agreeing the sale.

General: Whilst we endeavour to make our sales particulars fair, accurate and reliable they are only a general guide to the property and accordingly if there is any point which is of particular importance to you please contact the office and we will be pleased to check the position for you. Buyers must check the availability of any property and make an appointment to view, before embarking on any journey to see a property. Items shown in photographs are NOT included unless specifically mentioned within the sales particulars. They may however be available by separate negotiation.

Measurements: These approximate room sizes are only intended as general guidance. You must verify the dimensions carefully before ordering carpets or any built in furniture.

Services: Please note we have not tested any apparatus, equipment, fixtures and fittings or services and so cannot verify that they are in working order or fit for the purpose. A Buyer is advised to obtain verification from their Solicitor or Surveyor. References to the Tenure of a Property are based on information supplied by the Seller. The Agent has not had sight of the title documents. A Buyer is advised to obtain verification from their Solicitor. These particulars are issued in good faith but do not constitute representations of fact or form part of any offer or contract.

01323 898414

[sales@davidjordan.co.uk](mailto:sales@davidjordan.co.uk)

[davidjordan.co.uk](http://davidjordan.co.uk)

*David Jordan*

EST. 2004